

LISTA DE MATERIAIS				
ITEM	QTDE	CÓD MATERIAL	DESCRIÇÃO	OBSERVAÇÃO
1	1	1-210-004-001	RH 70 - SUPORTE UNIVERSAL P/ PLAINAR CABECOTE	OPCIONAL
2	1	1-340-020-058	KIT SUPORTE INSERTO RED Ø6(ALUMINIO) E Ø8(FERRO FUNDIDO) P/ ALOJAMENTO Ø15,87MM P/ PLAINAS	OPCIONAL
3	1	1-346-010-001	PROLONGADOR DO DISCO DE Ø264 P/ Ø400MM - FERRAM Ø15,87MM P/ PLAINA PC 900 NG	OPCIONAL
4	1	1-346-011-001	KIT DE FIXACAO DO BLOCO MERCEDES OM 352 P/ PLAINAS PC 900 / PC 900 CM / PC 900 NG	OPCIONAL
5	1	1-346-012-001	CONJ DE CAVALETE P/ PLAINA PC 850 / 900 NG - 25 X 410MM	
6	1	1-346-013-001	CONJ DE CAVALETE P/ PLAINA PC 900 / 900 CM / 900 NG - 120 X 370MM	
7	1	1-346-014-001	CONJ DE CAVALETE P/ PLAINA PC 900 NG - INCLINADO P/ FIAT FIASA	
8	1	2-340-001-001	SUPORTE DO RELOGIO COMPARADOR HASTE Ø15,8MM	
9	5	4-050-001-004	SAPATA SEXTAVADA DO PE NIVELADOR - MOD ALTO	
10	5	4-050-002-002	PARAF NIVELADOR DA SAPATA - MOD PINO Ø11 X 19MM	
11	4	4-210-047-001	GRAPA DE FIXACAO P/ BLOCO E CABECOTE	
12	4	4-346-096-001	BORRACHA DE APOIO DOS CAVALETES 50 X 50MM	
13	8	4-346-097-001	HASTE ROSCADA M12 X 70MM - FUSO P/ GRAPA COM FIXACAO NO RASGO T DO CVALETE	
14	2	4-346-098-001	HASTE ROSCADA M12 X 140MM - FUSO P/ GRAPA COM FIXACAO NO RASGO T DA MESA	
15	8	4-650-012-030	PORCA T M12 - MAT ACO - P/ PLAINAS PC 850 / PC 900 NG / RH 4110 NG / RH 4150 NG - P/ CANAL 20MM	
16	8	5-100-045-000	PORCA SEXT M12 - ZB - DIN 934	
17	8	5-100-078-000	ARRUELA LISA Ø12MM - ZB - DIN 125 A	
18	5	5-100-520-000	CONTRAPINO Ø2,5 X 25MM - ZB - DIN 94	
19	1	5-100-787-000	BOMBA MANUAL INJ OLEO 120GR MACHO 103	
20	1	5-102-960-000	MANUAL DE OPERACAO PC 900 NG	
21	1	5-400-144-000	RELOGIO COMPARADOR 0 - 10MM S/ SUPORTE DIGIMESS 121304 BASIC	
22	1	5-400-581-000	CHAVE ALLEN 4,0MM LONGA ABAULADA	
23	1	5-401-258-000	FERRAMENTA CORTE PLAINA Ø15,87 CH DIR RH12 FEFE	
24	2	5-401-259-000	FERRAMENTA CORTE PLAINA Ø15,87 CH DIR RH13 ALUMINIO	

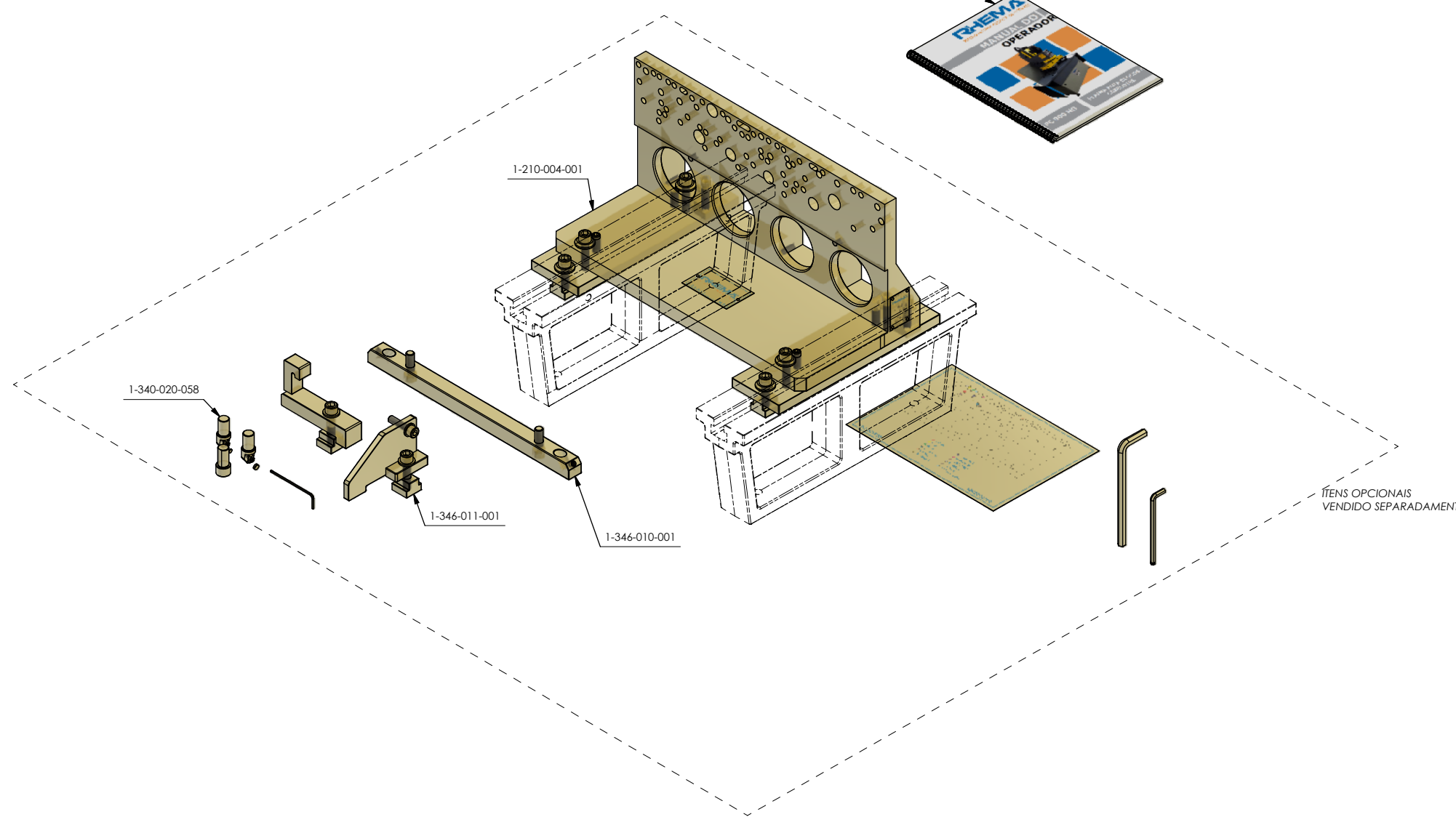
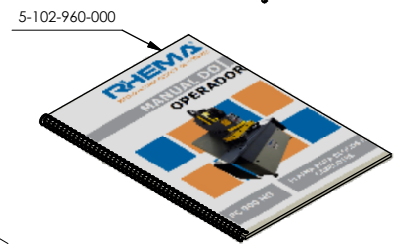
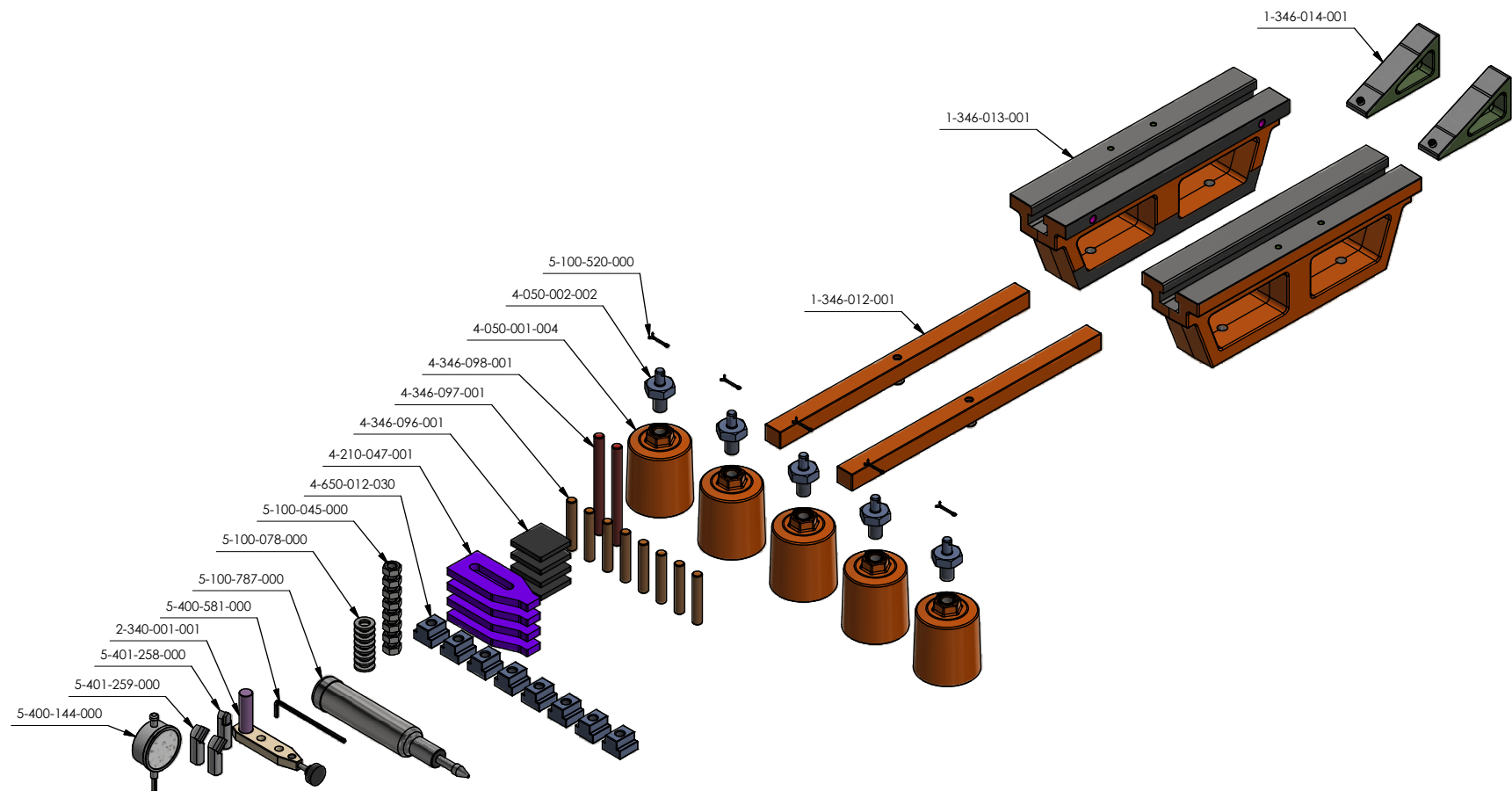

ÍTEMS OPCIONAIS
VENDIDO SEPARADAMENTE